

Urban Planners as Integrators

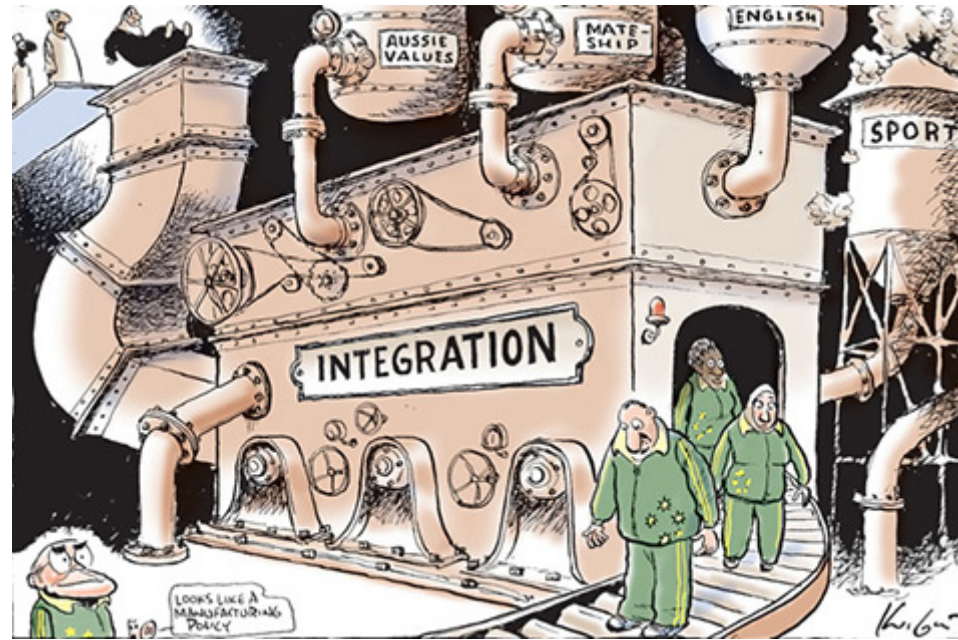

Prof. Dr. **Jan Schreurs** (PhD, MSc Eng Arch, MSc Urbanism & Planning) **University of Leuven**

Research Group Planning & Development, Dep. ASRO,
Faculty of Engineering Science,

Research Group Collective Structures, LUCA,
Faculty of Architecture

jan.schreurs@asro.kuleuven.be

KU LEUVEN



First I felt honored by the invitation



First I felt honored by the invitation
Then I became worried by the title

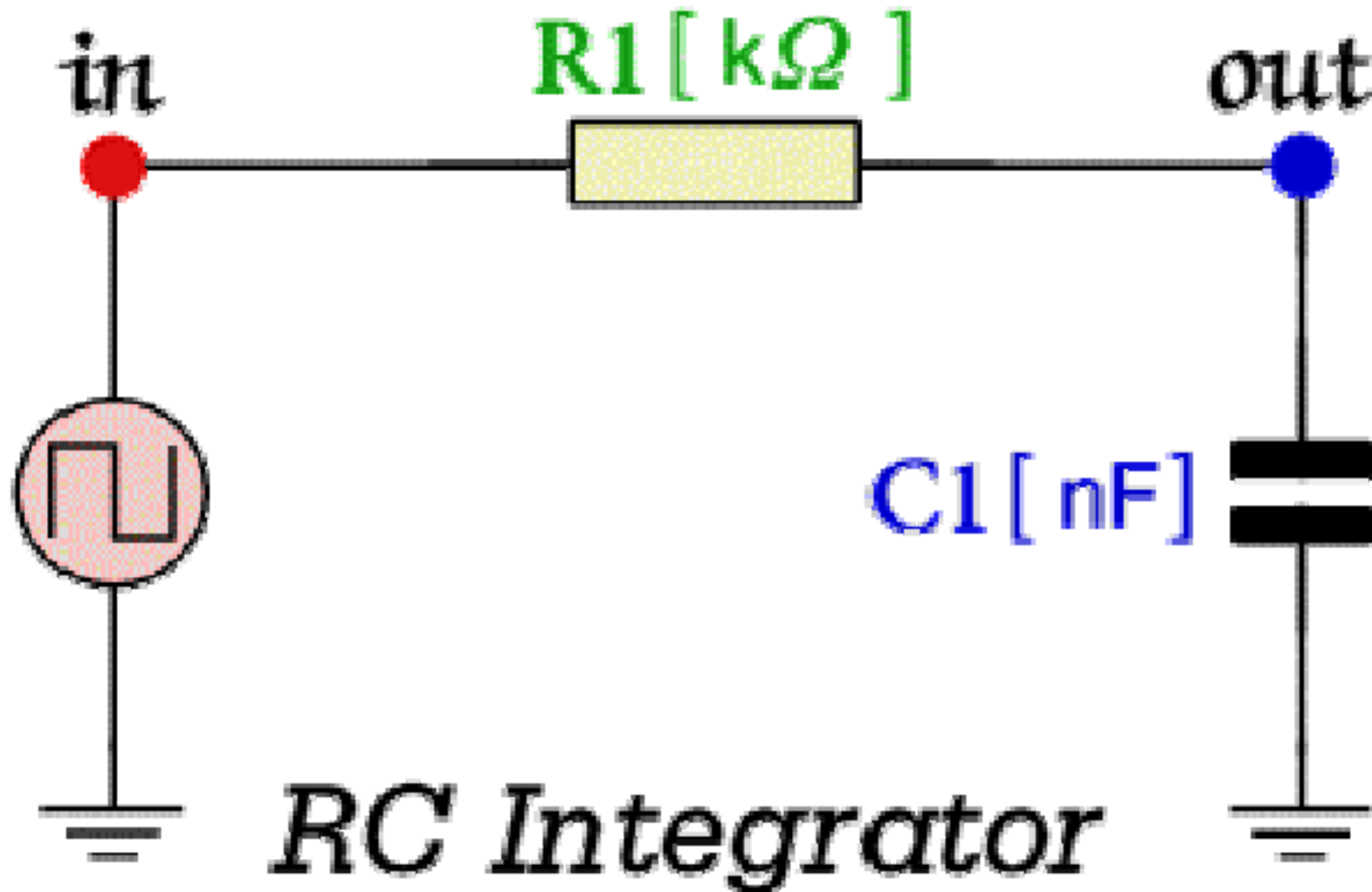

First I felt honored by the invitation
Then I became worried by the title
Next I was puzzled by the issue



First I felt honored by the invitation
Then I became worried by the title
Next I was puzzled by the issue
Now I am glad to announce:

...



First I felt honored by the invitation
Then I became worried by the title
Next I was puzzled by the issue
Now I am glad to announce:
'there is no need for integration!'



Success factors for an integrated approach (summary)

- **Clear communication:** the major bottleneck for collaboration is formed by the **different ‘languages’** used by different disciplines (like environmental engineers, spatial planners/designers/architects, project developers) involved in urban spatial planning and development. These professionals appear to be living in **different worlds** and working on different goals and ambitions. And then there are also stakeholders like politicians, inhabitants, owners, users with their own agenda.
- **Enlarge the area** for the business case.
- Broaden your horizon: consider all relevant activities and interests in the area and consider enlarging the area if this allows for **additional resources**.

OUTLINE

- (Introduction)
- Integrative experiments
- Integrative strategies
- Something wrong with our lenses?
- From integration to specification
- Conclusions
- Questions



PRAKtijk: workshops Public Space and Architecture at the Coast (1)

What could/should be integrated?

- consecutive phases (thus disciplines) of projects for 'public space'
- divergent policy domains

Why should we integrate?

- to enhance the coherence of the process ... & improve the product

How can we manage those integrations?

- process management (e.g. periodical coordination meetings of all administrations involved)
- think ahead into the next phases (e.g. consider management and repair already during design phase)
- learn from previous experiences

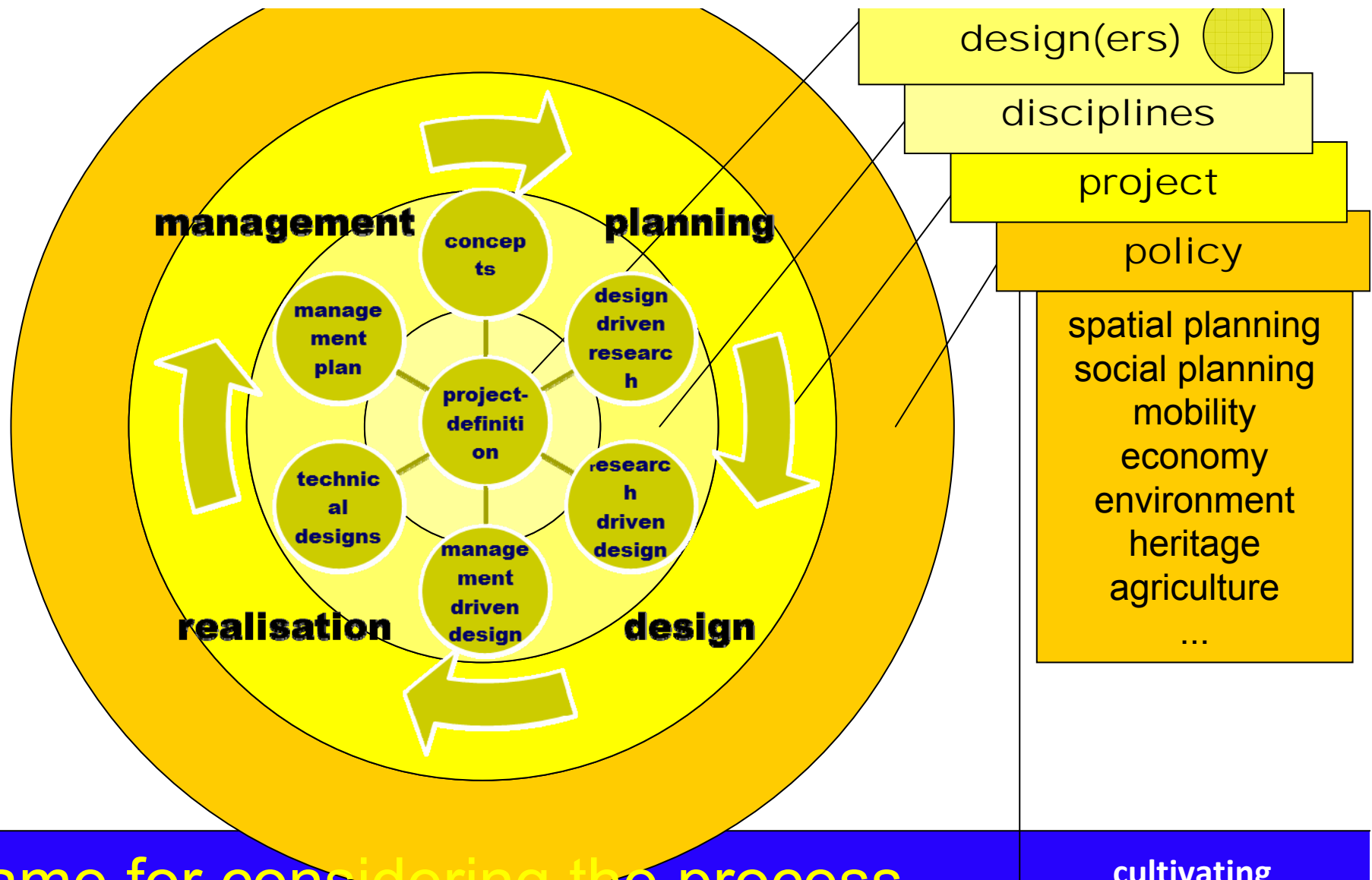

frame for considering the process

- ° coordination of phases & disciplines
- ° integration of policy sectors
- ° central role of designing

cultivating
difference:
workshops
on quality
jan schreurs

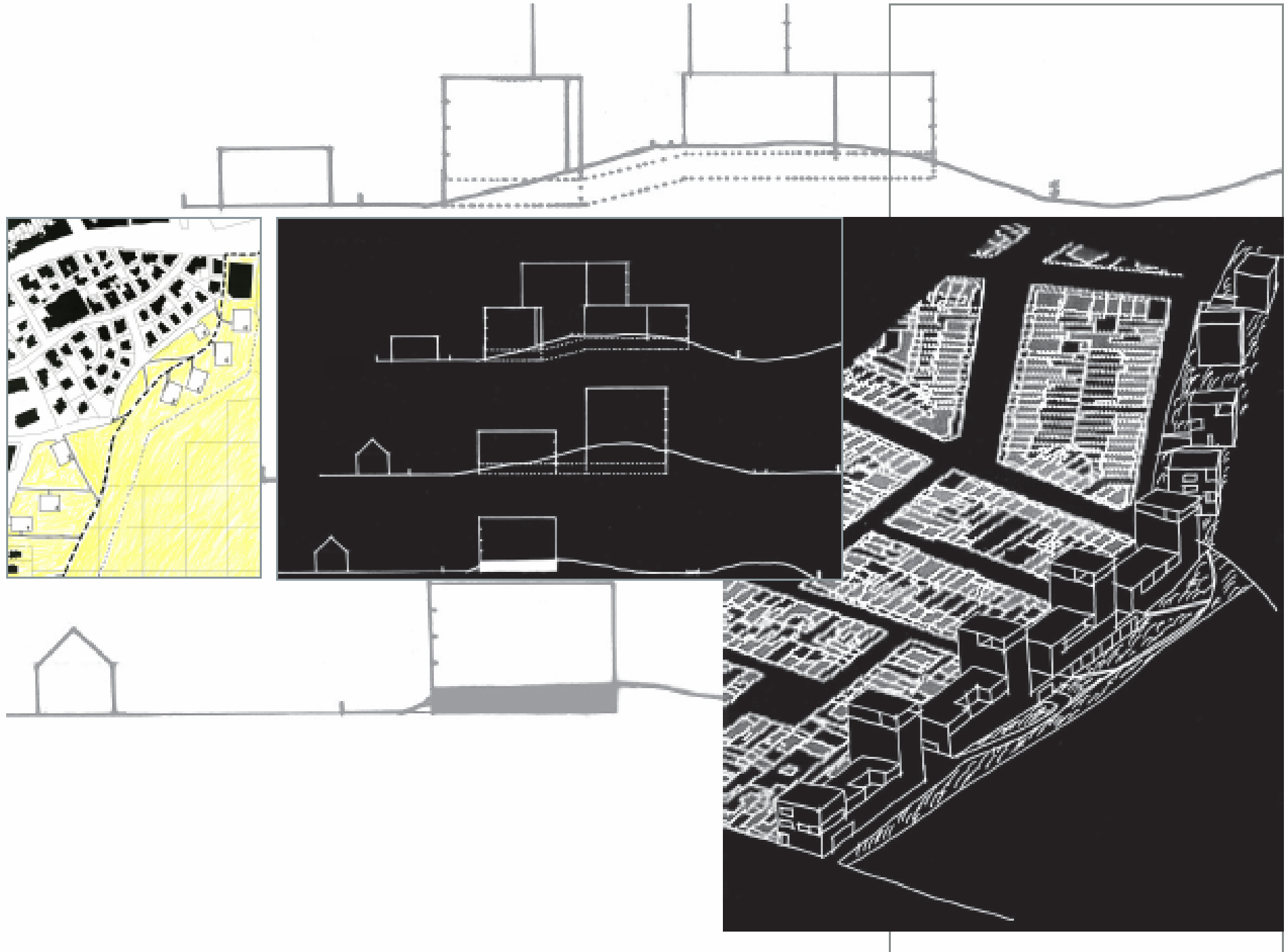

PRAKtijk: workshops Public Space and Architecture at the Coast (2)

What could/should be integrated?

- multiple stakeholders' interests
- multiple performance dimensions of 'public space' projects (~ qualities)

Why should we integrate?

- to balance conflicting values/qualities and interests
→ improve the product

How can we manage those integrations?

- start discussions from shared values/qualities (SD)
- discuss in concrete terms, guided by 'indicators' within a values/interests frame
- test & improve project definition by designerly research

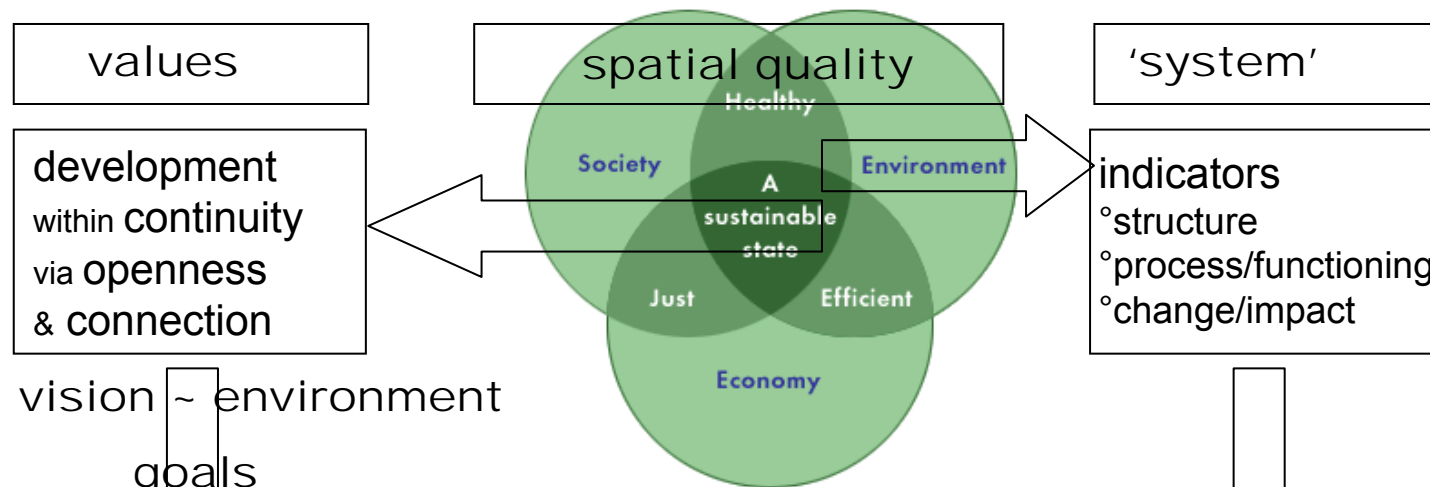

CONTENT

workshop

working

instruments

success factors

dimensions	subdimensions	criteria	indicators
vitality	sustenance, safety, consonance, genetic diversity, stability	when does the place fulfill the expectations?	
sense	identity, structure, congruence, transparency, legibility, significance		
fit	stability of match, manipulability, resilience		
access	diversity, equity, control		
control	certain, responsible, congruent		

indicators within a value-led conceptual frame

- °quality is based on a vision about sustainable development
- °quality is defined in terms of performance (sub)dimensions
- °criteria help to analyse dimensions into 'measurable' scales
- °indicators make discussions on quality concrete
- ° " help to indicate the 'value' of a place on the dimensions

communicating
quality

jan schreurs

18.01.11

14

Spatially qualitative industrial/trading parks: criteria analysis

What could/should be integrated?

- 3 Flemish administrations: economy, environment, spatial planning

Why should we integrate?

- address & relate key-factors for integrated sustainable development

How can we manage those integrations?

- articulate values (in stead of formal solutions) of each administration by discussing concrete exemplars
- identify common goals in order to raise awareness of basic 'mission statement' (e.g. location policy)
- create a shared language to discuss qualities (dimensions, themes, criteria)

ABSTRACT

KWALITEITSDIMENSIES

Thema's

BELEEFBAARHEID

Authenticiteit
Structuur
Identiteit

TOEGANKELIJKHEID

Doordringbaarheid
Betreedbaarheid
Bereikbaarheid

GESCHIKTHEID

Medegebruik
Multifunctionaliteit
Passendheid

ONDERSTEUNING

Veiligheid
Management en beheer
Draagvlak

CONCREET

Ideeënboek
Kwalitatieve
bedrijventerreinen

Ruimtelijk relevante kwaliteitsdoelstellingen definiëren, herkennen
en vertalen naar concrete maatregelen voor de stedenbouwkundige inrichting

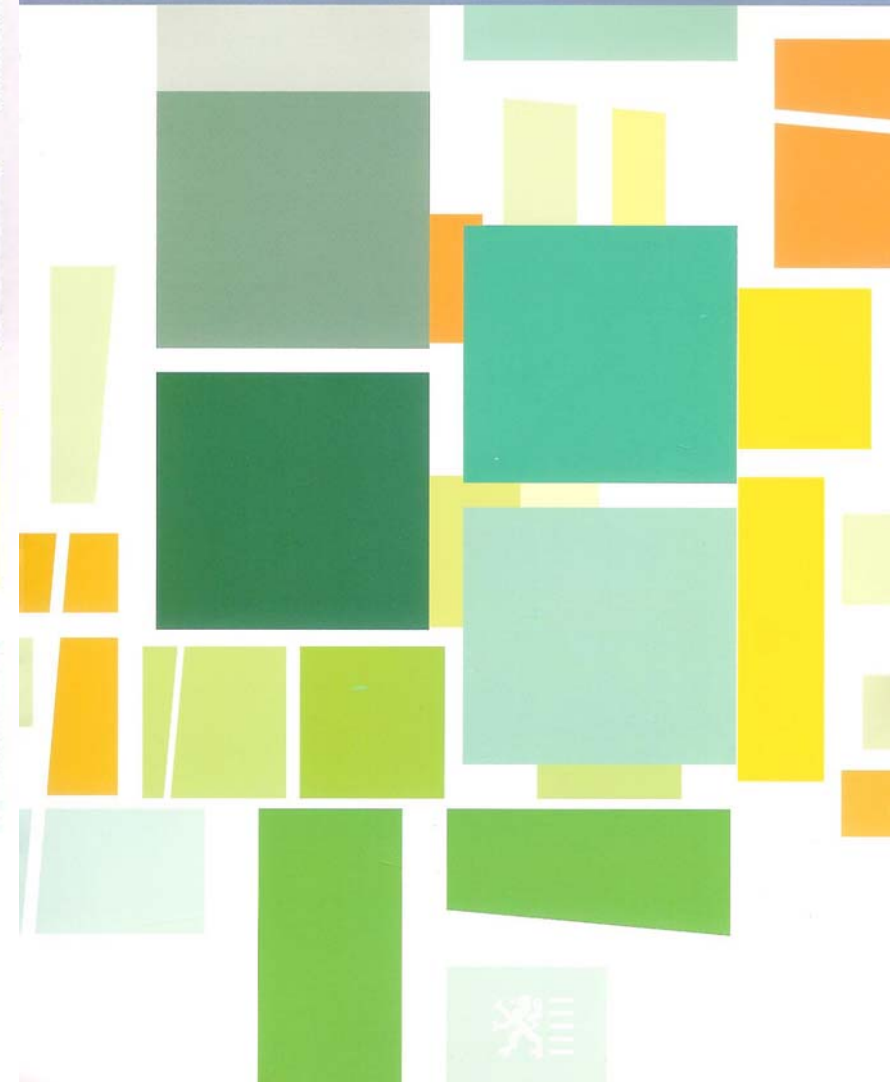

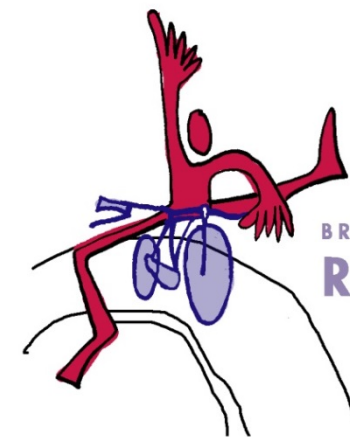

BRUGGEN NAAR
RABOT

Bruggen naar Rabot / Bridging Rabot

What could/should be integrated?

- spatially isolated neighborhood into the city fabric
- ambitions of different city administrations (technical, financial, spatial, social ...)

Why should we integrate?

- social and spatial innovation needed (for 19th century belt)
- improve capacity (of administrative body) to coördinate

How can we manage those integrations?

- plenary discussions fueled by designerly research
- area-oriented actions (iso 'problem'- or site-oriented)
- procedure of 'concept/capacity subsidy' (Flemish city policy), incl. expectation of larger subsidy (urban renewal)

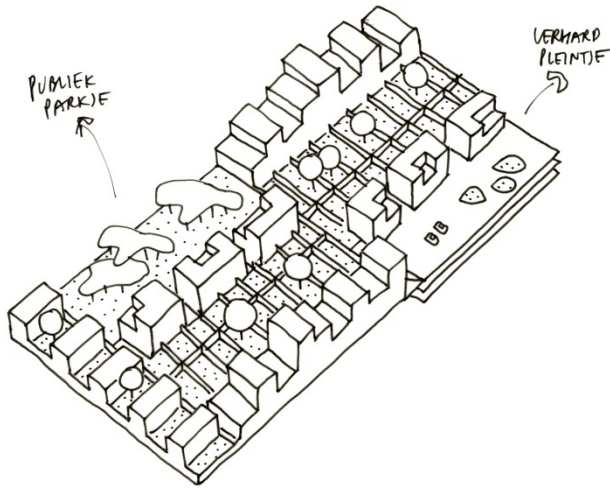

BRUGGEN NAAR RABOT

Location & projects

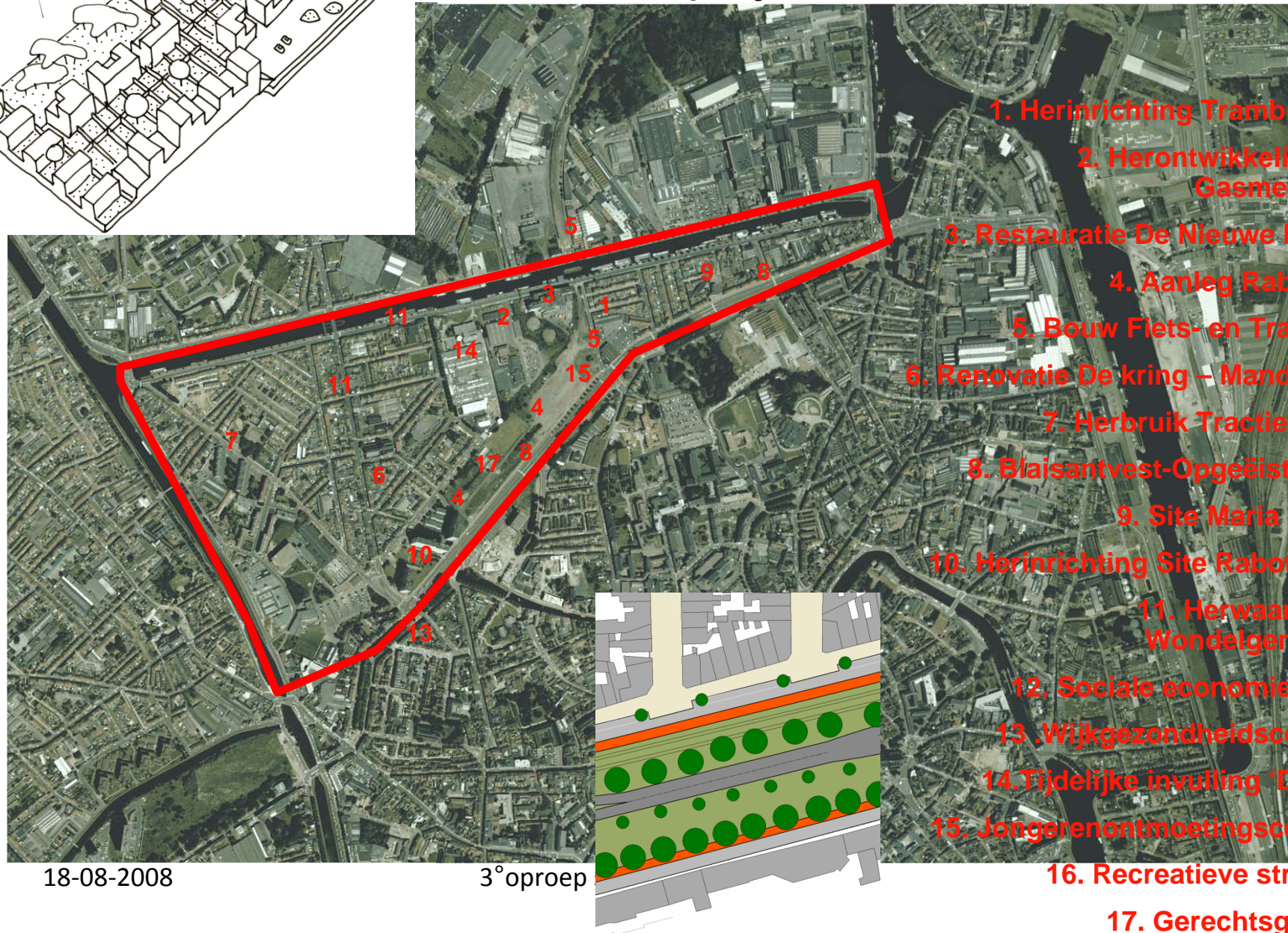

1. Herinrichting Trambrugsite

2. Herontwikkeling site
Gasmeterlaan

3. Restauratie De Nieuwe Molens

4. Aanleg Rabotpark

5. Bouw Fiets- en Trambrug

6. Renovatie De kring – Mandala bis

7. Herbruik Tractiestation

8. Blaisantvest-Opgeëistenlaan

9. Site Maria Goretti

10. Herinrichting Site Rabottorens

11. Herwaardering
Wondelgemstraat

12. Sociale economie Rabot

13. Wijkgezondheidscentrum

14. Tijdelijke invulling 'De Site'

15. Jongerenontmoetingscentrum

16. Recreatieve structuur

17. Gerechtsgebouw

18-08-2008

3°oproep

STADSGASFABRIEK

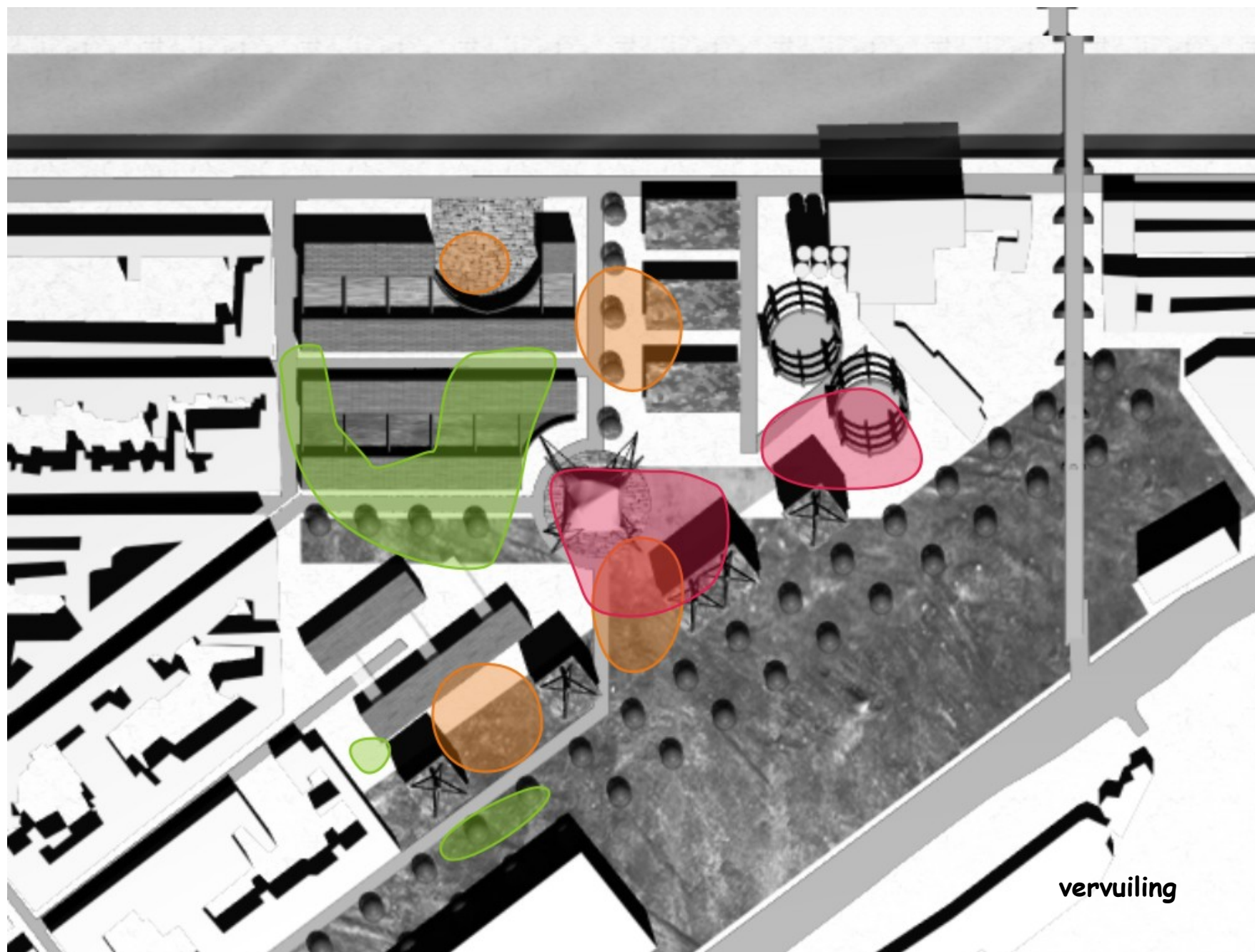

MASTER PLAN OF NIEW ZUID

STUDIO 012- Bernardo Secchi & Paola Vigano

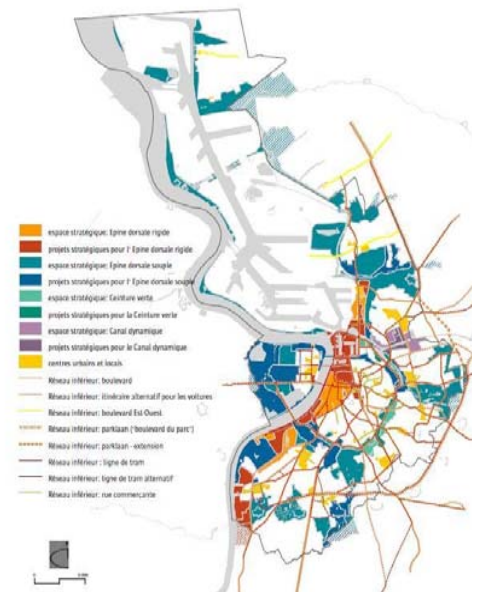

Studio Strategic Spatial Planning

What could/should be integrated?

- theory and practice
- academia and 'the wild'
- different group identities (students [from ≠ cultures], coaches, stakeholders, jury)

Why should we integrate?

- learning by doing is more effective than abstract teaching
- to frame complex, wicked, evolving situations/problems

How can we manage those integrations?

- working on real cases, with transdisciplinary approach
- identifying, articulating and 'staging' roles
- generative metaphors (e.g. urban editor, learning ecology)

Studio as Journey (of an Editor)

- For coaches, as much as for the students, the studio was a **journey** upon which we were **embarked together**, with no knowing what we might **discover** ...
- We embarked for **wayfaring**: studying and making **with** each other, **with** the actors/authors, **discussing and defining** paths in the course of the finding
- On our way – as **urban editors** – we discovered what it means to **engage** in a project, to have to **understand** each other, to **invent** for a purpose, to **involve** people, to critically **correct** ...



Integrative strategies

- **shared basic values:** sustainable development, carrying capacity, spatial quality
- **inclusion of qualities,** framed by {values x interests}
- **‘rainbows’ of qualities:** coherences, complementarities
- **concrete discussions,** stimulated by qualitative indicators & criteria
- **process management:** disciplines, administrations, policy
- **research by design:** test (what if?), enrich, envision
- **role playing:** take position, provoke, engage
- **metaphors:** inspiration, model, evaluation
- ...

Something wrong with our lenses?

What if ...

- we would see the social 'fabric' as a 'meshwork'?



Something wrong with our lenses?

... then we would see

- wayfaring instead of connecting pre-defined points!

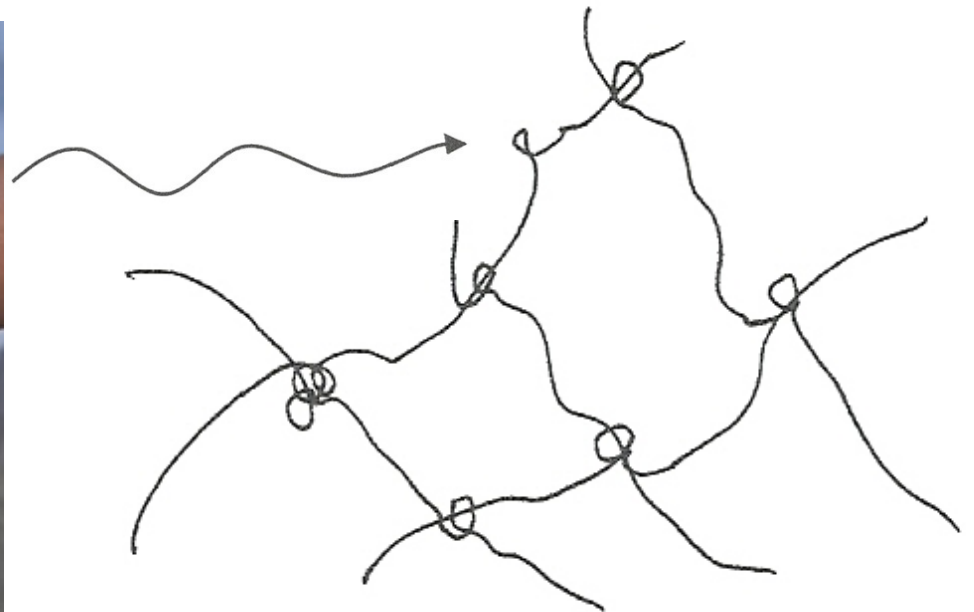

Something wrong with our lenses?

What if ...

- we would take the metaphor of a 'living' city serious?



Something wrong with our lenses?

... then we would see

- “development, within continuity, via openness and connection” (Lynch K., *Good City Form* , 1981, pp. 116-117)



Something wrong with our lenses?

What if ...

- we would conceptualize rather from the totality in stead of from the parts?



Something wrong with our lenses?

... then we would see

- less difficulties in bringing parts together in a coherent 'wholeness'!

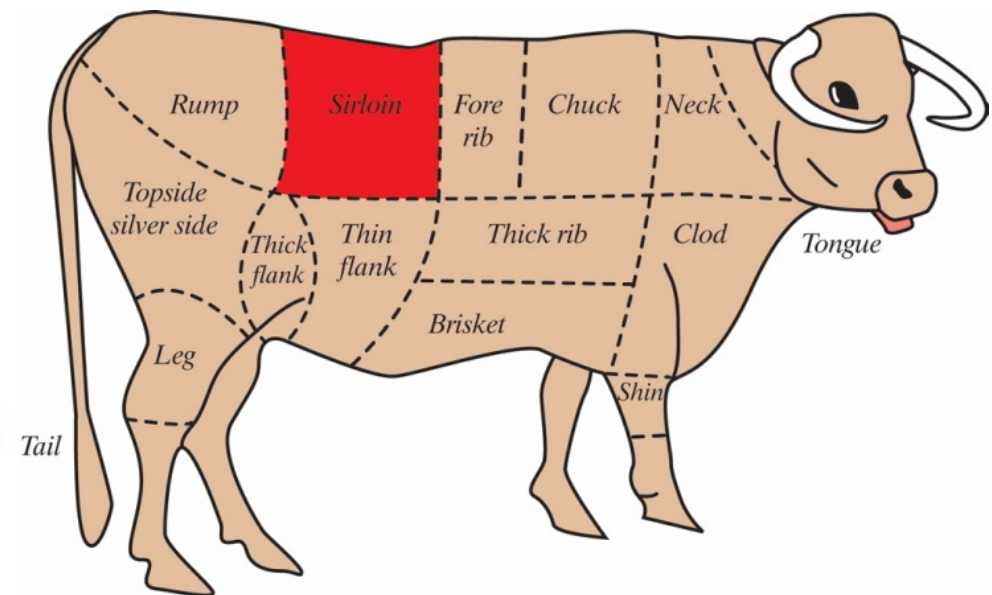

Something wrong with our lenses?

What if ...

- we would see the city as 'becoming'?



Something wrong with our lenses?

... then we would see

- a becoming which is anti-compositional, fluid, processual and improvisatory ...



From integrating to specifying

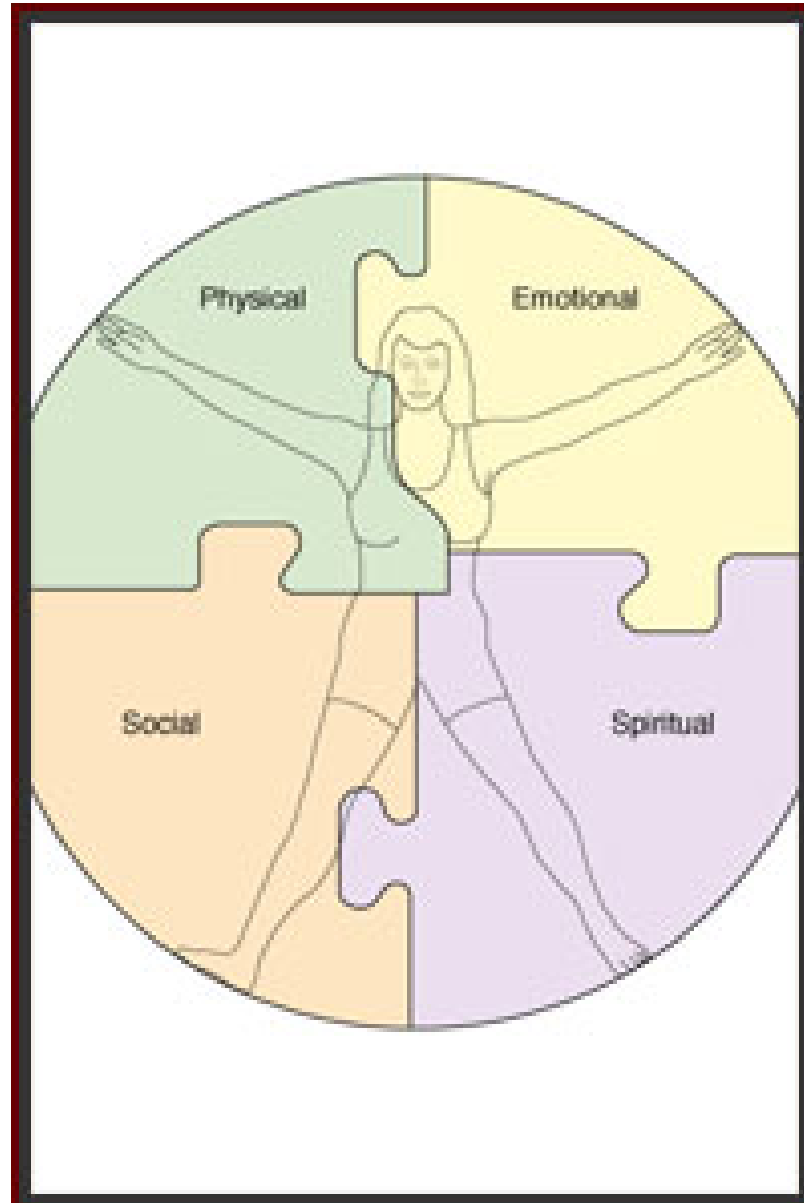

From integrating to specifying

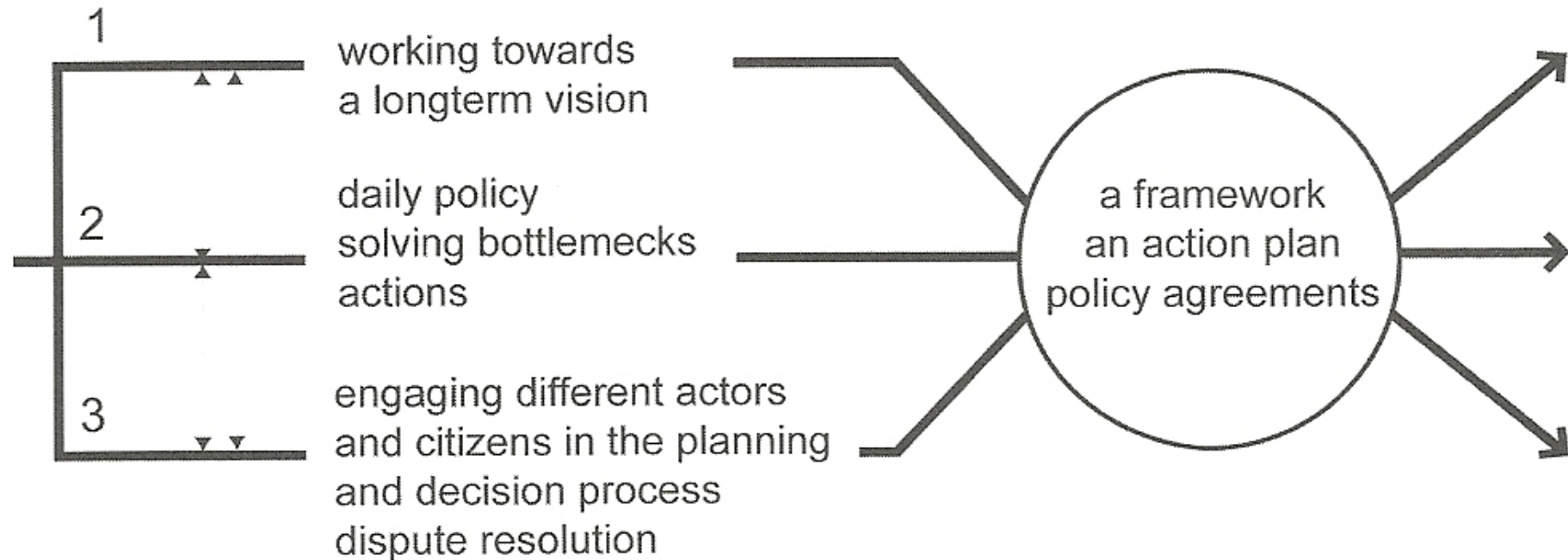

Conclusions

- start from the **totality**, not from the parts
- go for **physical** and **social** aims and 'means'
- apply **ecological** concepts to environmental 'problems'

"An **ecology** is basically an open, complex adaptive system comprising elements that are dynamic and interdependent. One of the things that makes an ecology so powerful and adaptable to new contexts is its diversity."

"A **learning ecology** [is] a collection of overlapping communities of interest (virtual), cross-pollinating with each other, constantly evolving, and largely self-organizing."

(Brown J., Growing up digital, 2000, p. 19)

Questions

role of integrator?

- interface between interests?
- facilitator of dialogues?
- guardian of agencies without a 'voice'?

role of administrations?

- write common ambitions into mission statement?
- start from a 'will to solve', not from the will to excel?
- think from the outside in (imagine the position of others)?

thank you !

